

Flexible duct insulation

FDFI

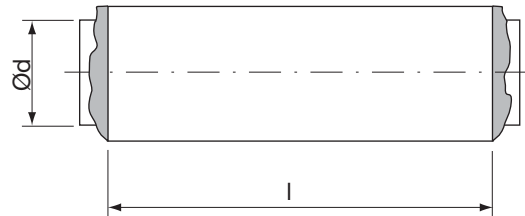

Dimensions



Description

Multiple layer Al/PET sleeve encapsulating fiber glass insulation with inner PE sleeve.

Classifications

M1 - CSTB

Technical data

Duct materials:	
inner wall (core).....	PE
insulation.....	25/50 mm fibreglass
outer wall (jacket).....	Multiple layers aluminium/ polyester
Temperature range	-30 to +125 °C
Packing	Rolled and strapped

Ød nom	O πd m	A πd ² /4 m ²	l mm	Max. pressure Pa
80	0,251	0,005	10000	+3000
100	0,320	0,008	10000	+3000
125	0,393	0,012	10000	+3000
150	0,478	0,018	10000	+3000
160	0,503	0,020	10000	+3000
180	0,565	0,025	10000	+3000
200	0,628	0,031	10000	+3000
250	0,785	0,049	10000	+3000
315	0,990	0,078	10000	+3000

Ordering example

	FDFI	160	10000	AP
Product	_____			
Dimension Ød	_____			
Length l	_____			
Material	_____			

- 1
- 2
- 3
- 4
- 5
- 6
- 7
- 8
- 9
- 10
- 11
- 12**
- 13
- 14
- 15
- 16
- 17
- 18